

Cadence Sensor



Cadence Sensor Rubber Rings x2

Specification

Product Name	SC20 Cadence Sensor
Model	SR-SCS20A
Communication	BLE 5.0 / ANT+
Battery Lifetime	460Hours
Waterproof	IP67
Battery	CR2032
Sensor Size	31.1mm*34.4mm*9.4mm
Weight	10g
LED Indicator	Red

Speed Sensor

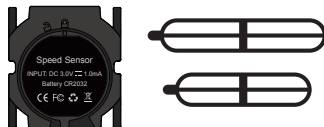

Speed Sensor Rubber Rings x2

Specification

Product Name	SP20 Speed Sensor
Model	SR-SCS20B
Communication	BLE 5.0 / ANT+
Battery Lifetime	250Hours
Waterproof	IP67
Battery	CR2032
Sensor Size	31.1mm*34.4mm*9.4mm
Weight	10g
LED Indicator	Green

First use

- 1 Unscrew the battery case cover anti-clockwise;
- 2 Take out the transparent plastic sheet;
- 3 Screw the battery case cover clockwise.



*Please keep the waterproof rubber ring seal around the edge of the case properly and firmly.

LED Indicator

When the sensor is activated or installed with new battery, the LED indicator keeps flashing for around 10 seconds.

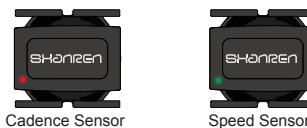

LED indicator for Cadence Sensor: RED
LED indicator for Speed Sensor: GREEN

Pairing with Di Pro(Cadence Sensor)



- 1 Keep pressing SET & MODE buttons to enter setting menu, press MODE to switch to the second icon.
- 2 Press SET to switch to "CAD" icon, press MODE to confirm, press SET again to search for speed sensor and pair.

After connected successfully, icon shows up on the computer screen.

- 3 The cadence data on the screen should vary when rotating the sensor.



Disconnecting

Enter the setting menu same as the Binding guide, when "..." appears under "CAD" icon, press both SET & MODE buttons quickly to unbind the sensor with the computer.

Pairing with Di Pro(Speed Sensor)



- 1 Keep pressing SET & MODE buttons to enter setting menu, press MODE to switch to the second icon.
- 2 Press SET to switch to "SPD" icon, press MODE to confirm, press SET again to search for speed sensor and pair.

After connected successfully, icon shows up on the computer screen.

- 3 The speed data on the screen should vary when rotating the sensor.

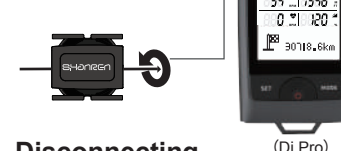

Disconnecting

Enter the setting menu same as the Binding guide, when "..." appears under "SPD" icon, press both SET & MODE buttons quickly to unbind the sensor with the computer.

Installation

Cadence Sensor Installation

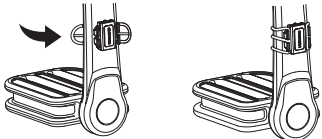

- 1 Select the rubber ring that fits your crank arm.
- 2 Put the cadence on the non-drive side.
- 3 Tighten the rubber ring around crank, attach them to the hooks on the sensor.

Speed Sensor Installation

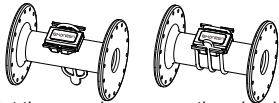

- 1 Put the speed sensor on the wheel hub and keep it in balance.
- 2 Tighten the rubber ring around the hub, attach it to the hook on the sensor.
- 3 Rotate the wheel to check the connection.

Pairing with Shanren Sport APP

Download App

Download Shanren Sport App. Please grant the app the following permissions, otherwise it will not work properly:



Turn on Bluetooth

Turn on Bluetooth on your phone. DO NOT pair the sensors via your phone's Bluetooth settings. If it has paired automatically, disconnect it.



Available on the App Store

Get it on Google play

sharen sport

Available on the App Store

Get it on Google play

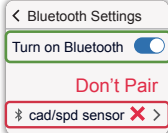

Connect the sensor

Open Shanren Sport App, go to devices - Add a new device. Click on the Cad sensor/Spd sensor icon and start scanning. Move the phone close to the sensor (within 3 meters) and select the device in the list to pair.

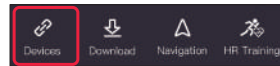

Add a new device



After the sensor being connected successfully with App, you can check the battery status of the sensor. Click 'Unbind' then the sensor will be disconnected.

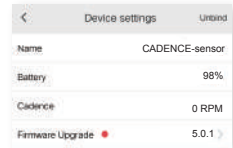

Cadence / speed data is alive when starts a cycling session.

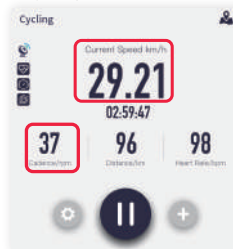

Pairing with 3rd Party Devices

Shanren Speed/Cadence sensor adopts BLE5.0 & ANT+ dual mode communication, it is compatible with bike computers, bike trainers and third-party sport Apps which support standard Bluetooth or ANT+ protocol.



When pairing with a third-party bike computer or other device, please follow the instructions of the third-party devices.

When pairing with a third-party App, please avoid pairing with the phone's Bluetooth directly. Instead, pair the sensor within the third-party App.

Warranty Card

Shanren products are covered under 1 year's warranty. Accessories excluded.

Each product unit is warranted to be free of factory defects for 1 year from original purchase. If the product fails to work through normal usage, we will repair or replace the defect at no charge. Service must be performed by an authorized Shanren dealers or an authorized Shanren retailers. To return the product, enclose its warranty card together with details about its dis-function. Please type your name and address clearly on the warranty card.

Insurance and transportation charges shall be born by the party requesting service. Thanks for understanding.

User name: _____

Address: _____

Telephone: _____

Order No.: _____

Dealer name: _____

Purchasing date: _____

